

HIGHWAY™ SPM-800 SERIES Medium Duty In-Helmet Microphone

PRYME®



MSRP \$63

Depending on connector; see pages 76-82

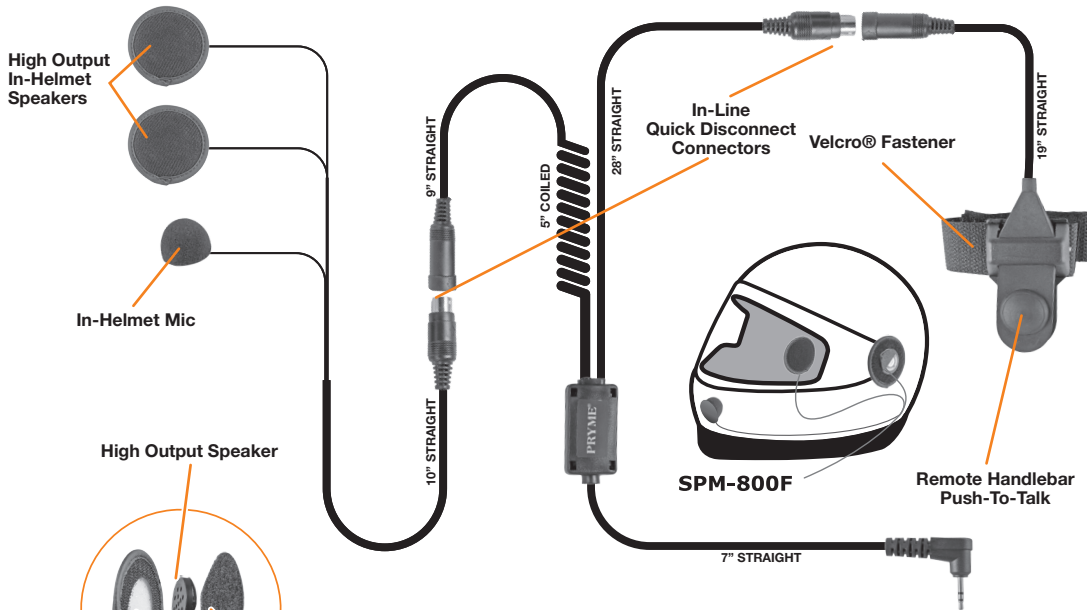

SPM-800F

Model	Connector
FOR ICOM, MIDLAND & MAXON RADIOS	
SPM-800F	X00
SPM-800FIL	X00IL
FOR KENWOOD & RELM RADIOS	
SPM-801F	X01
FOR HYT/HYTERA & MOTOROLA RADIOS	
SPM-803F	X03
SPM-813F	X13
SPM-863F	X63
FOR VERTEX & YAESU RADIOS	
SPM-800F	X00
SPM-802F	X02
SPM-842F	X42

See pages 76-82 for connector images.

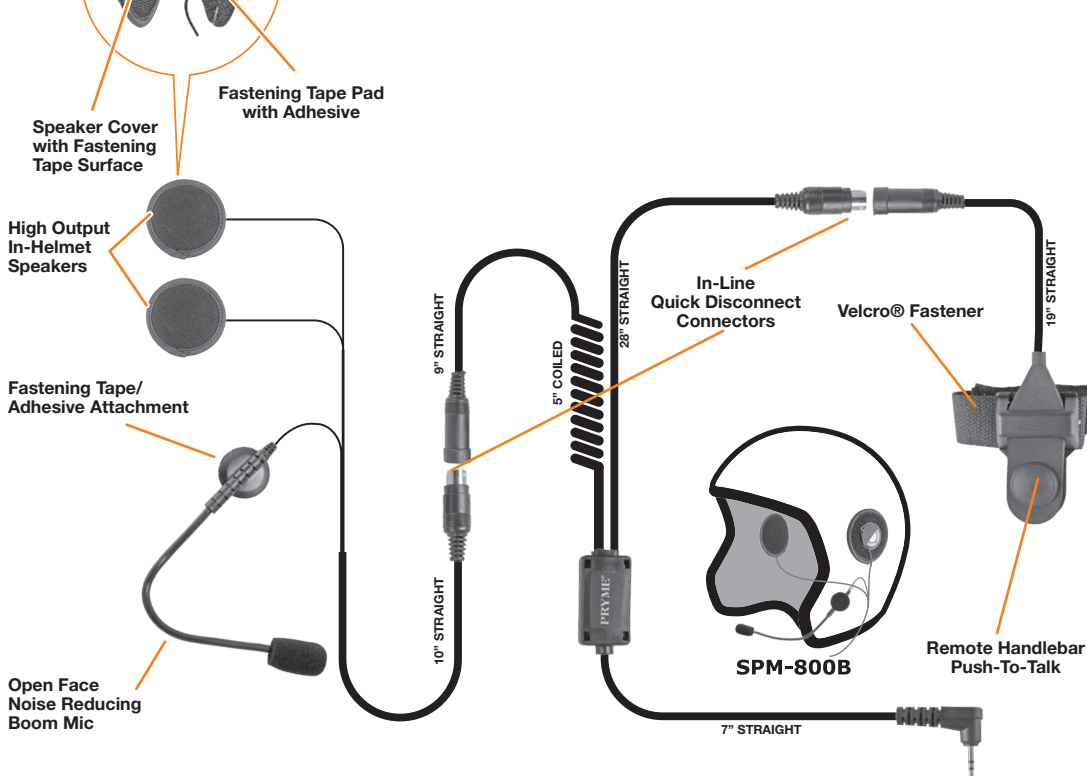

SPM-800B

Model	Connector
FOR ICOM, MIDLAND & MAXON RADIOS	
SPM-800B	X00
SPM-800BIL	X00IL
FOR KENWOOD & RELM RADIOS	
SPM-801B	X01
FOR HYT/HYTERA & MOTOROLA RADIOS	
SPM-803B	X03
SPM-813B	X13
SPM-863B	X63
FOR VERTEX & YAESU RADIOS	
SPM-800B	X00
SPM-802B	X02
SPM-842B	X42

See pages 76-82 for connector images.

FEATURES

- Medium duty, in-helmet motorcycle mic system
- Powerful in-helmet speakers allow the user to hear radio transmissions over road noise
- High-quality electret condenser element produces excellent transmit audio
- Handlebar mountable Push-To-Talk switch for convenient communications
- Installs into helmet using only two-sided fastening tape. No drilling of holes is required
- Modular features allow the mic system to be easily disconnected from the motorcycle
- Available for both open faced (SPM-800B) and full faced (SPM-800F) helmets

For Bluetooth version,
use BTH-300-KIT 7
(pg. 10)

HEADSETS